

# KEEP YOUR HEALTH PLAN AT YOUR FINGERTIPS



**You probably use your cell phone for a lot more than making phone calls.** With the easy-to-use mobile app from Blue Cross & Blue Shield of Rhode Island (BCBSRI)—**Your Blue Touch RI**—you can use your phone to manage your health plan anytime, anywhere. From checking covered services to checking on your deductible, you'll stay connected with Your Blue Touch RI.

## Download Your Blue Touch RI mobile app

1. Download the app from the Apple® App Store or Google® Play.
2. Open the app from your phone.
3. Click on the “sign up” link and follow the prompts.



Apple® and the Apple logo are trademarks of Apple Inc., registered in the U.S. and other countries. App Store is a service mark of Apple Inc. Google® Play is a trademark of Google Inc.



[More information >](#)

## Register your account with a photo

To register your account, take a picture of your Blue Cross & Blue Shield of Rhode Island (BCBSRI) ID card. That's it—there's nothing to key in. When you visit your healthcare provider, show your ID card on your phone.

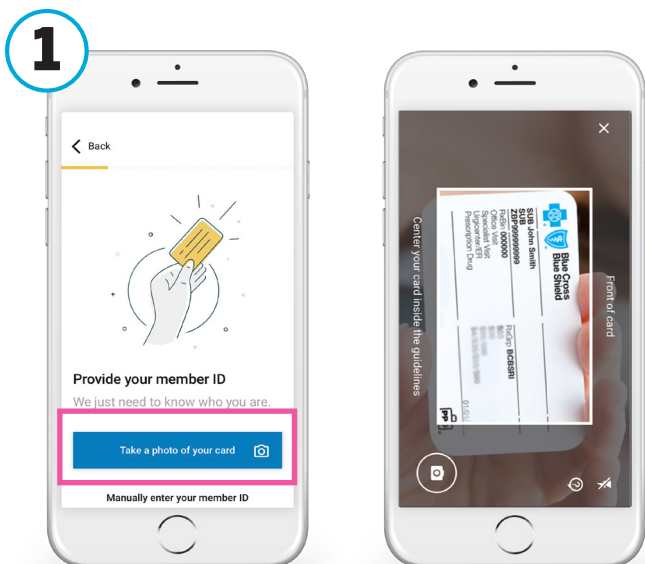

## Choose your log-in method

Log in to your account with your cell phone number or email address—whichever you prefer. Choose one method when you first verify your account, and then use that same method every time you log in.

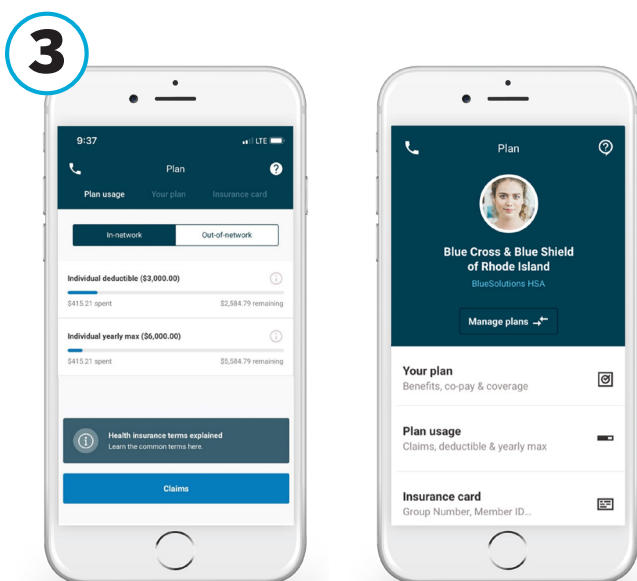
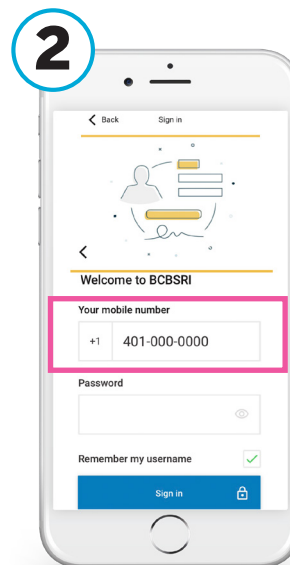

## Get at-a-glance plan information

The plan overview screen offers easy access to important information such as claims and deductibles, benefits and copays, and ID card details—so you'll always be in-the-know.

4

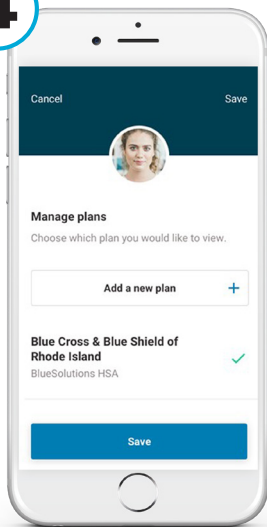

## Manage multiple plans

Add and manage any secondary BCBSRI insurance, if applicable, or add a new member ID if you switch plans. Your preferred log-in method (phone number or email) gives you access to it all.

## Understand plan usage

Wondering how insurance claims were applied to your deductible? Can't remember your out-of-pocket maximum? The plan usage screen lists everything in one convenient place.

5

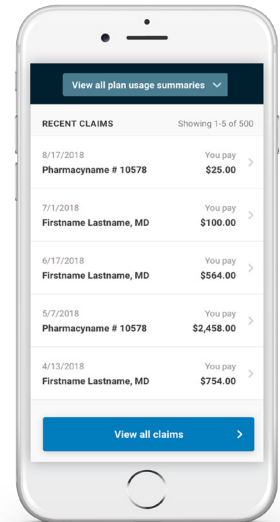
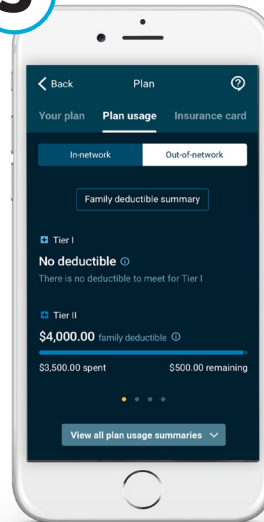

6

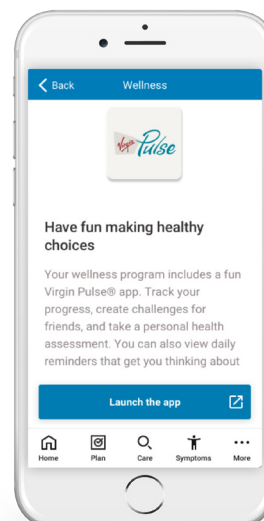
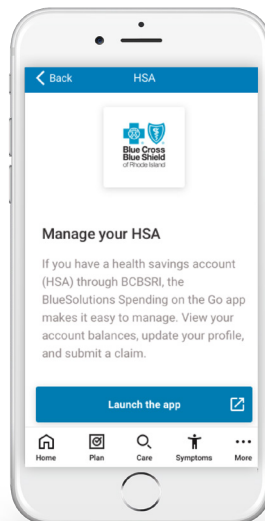
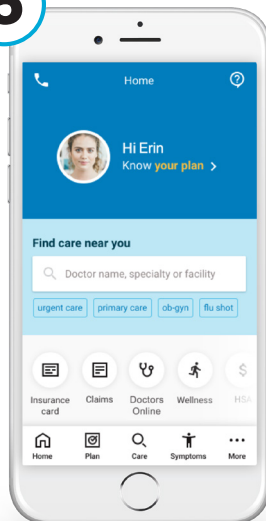

## Connect to your HSA, wellness program, or Doctors Online

Whether you want to track your steps or track the balance in your Health Savings Account (HSA), you can get to it all from here. We'll even connect you with Doctors Online\*\* for a virtual doctor's visit. Simply click on the appropriate icon to launch the app you need.

\*Standard mobile phone carrier and data usage charges apply. The downloading and use of Your Blue Touch RI mobile app is subject to the terms and conditions of the app and the online stores from which it is downloaded. Apple, the Apple logo, and iPhone are trademarks of Apple Inc., registered in the U.S. and other countries. App Store is a service mark of Apple Inc. Android and Google Play are trademarks of Google Inc.

\*\*Doctors Online is a telemedicine service provided by American Well®, an independent company that administers Doctors Online on behalf of Blue Cross & Blue Shield of Rhode Island.

## HAVE QUESTIONS?

**We're here to help!**

Call the State of Rhode Island Employee CARE Center at  
(401) 429-2104 or 1-866-987-3705

Monday – Friday, 8:00 a.m. – 8:00 p.m.

Saturday, 8:00 a.m. – noon

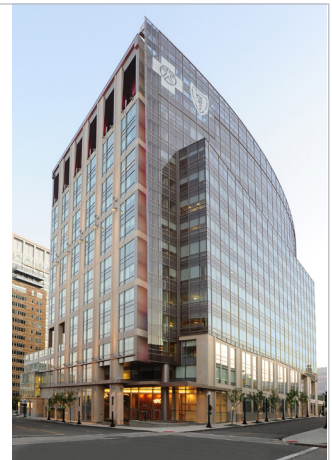

**IT'S WHAT  
WE LIVE FOR<sup>SM</sup>**



500 Exchange Street, Providence, RI 02903-2699

Blue Cross & Blue Shield of Rhode Island is an independent licensee  
of the Blue Cross and Blue Shield Association.